

NOTICE!!

These documents have been scanned!

Do not place un-scanned documents beneath this notice!

Do not remove this notice from this file!

GPO Jacket No. 560-102
Print Order 61540
Rise Business Services, LLC
Job=AZ15 7/11/2019



Box Number= AZ15155



Claim Begin-End: AMC452352-AMC452355

1 Initial Receipt



AZ15155-2

AMC452349-AMC452348

United States Department of the Interior
Bureau of Land Management
 DIV OF LANDS, MINRLS & ENERGY
 ONE N CENTRAL AVE
 PHOENIX, AZ 85004 -4427
 Phone: 602-417-9200

Receipt

No: 4294006

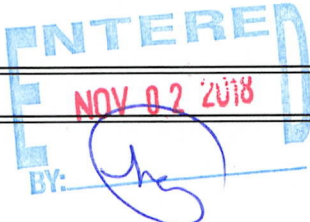
Transaction #: 4410128	
Date of Transaction: 10/29/2018	
CUSTOMER:	
JOHN MATHIS PO BOX 712 CONGRESS, AZ 85332-0712 US	

LINE #	QTY	DESCRIPTION	REMARKS	UNIT PRICE	TOTAL
1	4.00	LOCATABLE MINERALS / MINING CLAIMS-NEW, UNADJUD, ONE OR MORE AUTH NOS / NEW MINING CLAIM PROCESSING FEE CASES: AMC452352/\$20.00, AMC452353/\$20.00, AMC452354/\$20.00, AMC452355/\$20.00		- n/a -	80.00
2	4.00	LOCATABLE MINERALS / MINING CLAIMS-NEW, UNADJUD, ONE OR MORE AUTH NOS / NEW MINING CLAIMS LOCATION FEE CASES: AMC452352/\$37.00, AMC452353/\$37.00, AMC452354/\$37.00, AMC452355/\$37.00		- n/a -	148.00
3	4.00	LOCATABLE MINERALS / MINING CLAIMS-NEW, UNADJUD, ONE OR MORE AUTH NOS / NEW MINING CLAIMS MAINTENANCE FEE CASES: AMC452352/\$155.00, AMC452353/\$155.00, AMC452354/\$155.00, AMC452355/\$155.00		- n/a -	620.00
4	1.00	LOCATABLE MINERALS / MINING CLAIMS-NOT NEW-UNADJUD, ONE AUTH NO. ONLY / MINING CLAIM MONEY RECEIVED CASES: AMC452352/\$620.00	ADDITIONAL PLACER FEES	- n/a -	620.00
5	2.00	IAC PRODUCTS / MAPS-BLM / SURFACE MGMT-(A-M) / BRADSHAW MOUNTAINS		4.00	8.00

TOTAL: \$1,476.00

PAYMENT INFORMATION				
NOTE: Items will appear on credit card statement as "Bureau of Land Mgmt CO".				
1	AMOUNT:	1476.00	POSTMARKED:	N/A
	TYPE:	CREDIT CARD	RECEIVED:	10/29/2018
	NAME:	MATHIS, JOHN PO BOX 712 CONGRESS AZ 85332-0712 US		
	CARD NO:	XXXXXXXXXXXX6044	AUTH CODE:	00750C
	NAME ON CARD:	JODY E LARSEN		
	SIGNATURE:			

REMARKS

This receipt was generated by the automated BLM Collections and Billing System and is a paper representation of a portion of the official electronic record contained therein.

NOTICE!!

These documents have been scanned!

Do not place un-scanned documents beneath this notice!

Do not remove this notice from this file!

GPO Jacket No. 560-102
Print Order 61540
Rise Business Services, LLC
Job=AZ15 7/11/2019



Box Number= AZ15155



Claim Begin-End: AMC452352-AMC452355

2 Correspondence



AZ15155-2

AMC452349-AMC452348

**NO
DOCUMENTS
FOUND**

NO DOCUMENTS FOUND
NO DOCUMENTS FOUND

NOTICE!!

These documents have been scanned!

Do not place un-scanned documents beneath this notice!

Do not remove this notice from this file!

GPO Jacket No. 560-102
Print Order 61540
Rise Business Services, LLC
Job=AZ15 7/11/2019



Box Number= AZ15155



Claim Begin-End: AMC452352-AMC452355

3 Transfers



AZ15155-2

AMC452349-AMC452348

452352

Return to:
Jody LARSEN
5650 E. Hop Toad Rd.
Kingman, AZ 86401

2019-0013711 QCD Page: 1 of 3
03/27/2019 11:06:10 AM
Leslie M. Hoffman
OFFICIAL RECORDS OF YAVAPAI COUNTY \$15.00
JODY LARSEN



QUIT CLAIM DEED

FOR VALUABLE CONSIDERATION, the sufficiency and receipt of which is hereby acknowledged,
John MATHIS does hereby forever quit claim all his right, title and interest in
the unpatented mining claims described on the supplemental attachment, attached hereto and incorporated
herein by reference, to The Boyz Place 2 NE JODY LARSEN

IN WITNESS WHEREOF, grantor has executed this instrument as of this 1 day of November, 2018

[Signature]

Exempt from A.R.S. 11-1133 and 11-1137(B) by A.R.S. 11-1134(A)(6)

See Exhibit "A"

STATE OF ARIZONA)
County of Maricopa) ss.

SUBSCRIBED AND SWORN TO before me, a Notary Public, this 20th day of Dec, 2018

By: John Mathis

Notary Public [Signature]

My Commission Expires 5/24/21

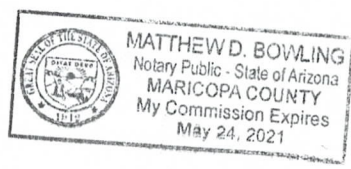

PHOENIX, ARIZONA
2019 APR 23 P 12:48
This form is available from the Arizona Geological Survey and may be reproduced.

TRF

Form MCF120
Revised July 2014

RECEIVED
PLM AZ STATE OFFICE

ENTERED
APR 29 2019
BY: RAM

Exhibit "A"



LOCATION NOTICE FOR PLACER MINING CLAIM

Amendment BLM Serial # _____

NOTICE IS HEREBY GIVEN that the **The Boyz Place 2** **NE** placer mining claim has been located by **John Mathis** whose current mailing address is:

PO Box 712, Congress, AZ 85332

BLM
Date
Stamp
2018 OCT 29 A 13:41
PHOENIX, ARIZONA

RECEIVED
BLM AZ STATE OFFICE

The general course of this claim is **North to South**

and it is situated in **Yavapai** County, Arizona. This claim is **1320** feet in length and **1320** feet in width.

40 Acres Total Claim Acreage. This claim runs from the location monument on which this location notice is posted at the **SW** corner of the claim approximately **1320** feet in a **North** direction from the **South** end line and **1320** feet in an **East** direction from the **West** end line. This claim is marked by four monuments, one at each corner of the claim. The location monument on which this notice is posted is situated within Section **20**, Township **9N**, Range **4W**, Gila Salt River Base and Meridian, Arizona. This claim encompasses portions of the following legal subdivision(s) if located by legal subdivision or the following quarter section(s), section(s), Township(s) and Range(s) **NE 1/4 of the NW 1/4 of Sec. 20, T9N, R4W**, Gila Salt River Base and Meridian, Arizona. The locality of this claim with reference to some natural object or permanent monument and additional information (if any) concerning its locality are as follows: **The NW corner of the claim is 1320' East of the NW Corner of Sec 20, T9N, R4W.**

The above information is shown on the attached map. DATED AND POSTED on the ground this **1st** day of **September**, 20**18**.

Locators:

Printed Name John Mathis Signature(s) 

Address: PO Box 712, Congress, AZ 85332

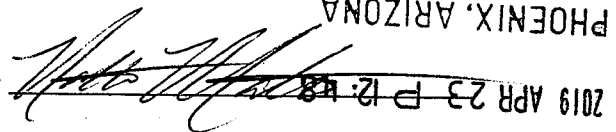
Printed Name Nannette Mathis Signature(s) 

Address: PO Box 712, Congress, AZ 85332

RECEIVED
BLM AZ STATE OFFICE
2018 APR 23 P 12:48
PHOENIX, ARIZONA

AR0952352

Jody LARSEN
Wendy LARSEN

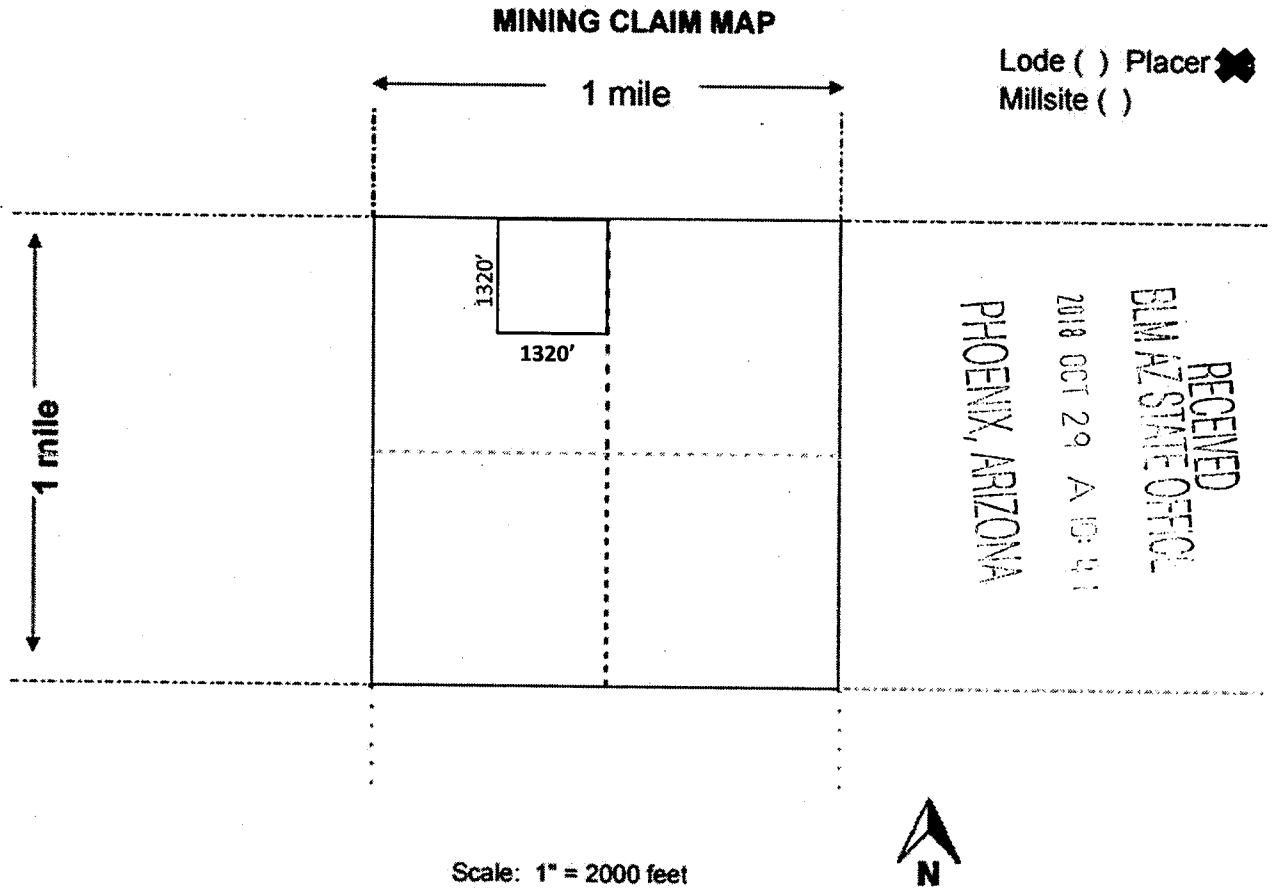

1. The above map depicts the **The Boyz Place 2 NE** mining claim, which is located in Section(s) **20**, Township **9N**, Range **4W**, Gila and Salt River Base and Meridian, **Yavapai** County, Arizona.

Total claim acreage is **40 Acres**.

2. The type of corner and location monuments used are as follows: **Capped PVC, Standing >5' tall.**

3. The bearings and distances in degrees and feet between claim corners and to a public land survey monument are as depicted on the map. **The NW corner of the claim is 1320' East of the NW Corner of Sec 20, T9N, R4W.**

4. If the claim is a placer or millsite claim with exterior limits conforming to legal subdivisions of the public survey, provide a legal description of the **NE ¼ of the NW ¼ of Sec. 20, T9N, R4W, of the Gila and Salt River Base and Meridian, Yavapai County, Arizona.**

A110452352

RECEIVED
BLM AZ STATE OFFICE
2019 APR 23 P 12:48

Return to:
Jody LARSEN
5650 E. Hop Toad Rd.
Kingman, AZ 86401



QUIT CLAIM DEED

FOR VALUABLE CONSIDERATION, the sufficiency and receipt of which is hereby acknowledged,
John MATHIS does hereby forever quit claim all his right, title and interest in
the unpatented mining claims described on the supplemental attachment, attached hereto and incorporated
herein by reference, to ~~The Boyz Place 2 NW~~ JODY LARSEN
LARSEN
IN WITNESS WHEREOF, grantor has executed this instrument as of this 1 day of November, 2018

Exempt from A.R.S. 11-1133 and 11-1137(B) by A.R.S. 11-1134(A)(6)

see Exhibit "A"

STATE OF ARIZONA)
County of Maricopa) ss.

SUBSCRIBED AND SWORN TO before me, a Notary Public, this 20th day of Dec, 2018

By: John Mathis

Notary Public

My Commission Expires 5/24/21

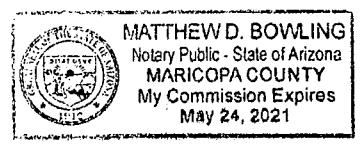

PHOENIX, ARIZONA

Form MCF120
Revised July 2014

This form is available from the Arizona Geological Survey and may be reproduced.

RECEIVED
PLM AZ STATE OFFICE

Exhibit "A"



LOCATION NOTICE FOR PLACER MINING CLAIM

Amendment BLM Serial # _____

NOTICE IS HEREBY GIVEN that the The Boyz Place 2
NW placer mining claim has been located by John
Mathis whose current mailing address is:

PO Box 712, Congress, AZ 85332

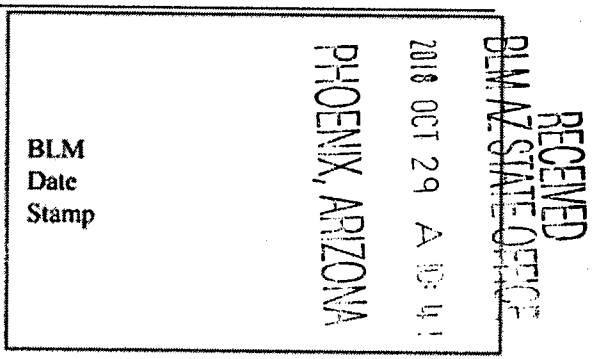

The general course of this claim is North to South

and it is situated in Yavapai County, Arizona. This claim is 1320 feet in length and 1320 feet in width.

40 Acres Total Claim Acreage. This claim runs from the location monument on which this location notice is posted at the SE corner of the claim approximately 1320 feet in a North direction from the South end line and 1320 feet in an West direction from the East end line. This claim is marked by four monuments, one at each corner of the claim. The location monument on which this notice is posted is situated within Section 20, Township 9N, Range 4W, Gila Salt River Base and Meridian, Arizona. This claim encompasses portions of the following legal subdivision(s) if located by legal subdivision or the following quarter section(s), section(s), Township(s) and Range(s) NW ¼ of the NW ¼ of Sec. 20, T9N, R4W, Gila Salt River Base and Meridian, Arizona. The locality of this claim with reference to some natural object or permanent monument and additional information (if any) concerning its locality are as follows: The NW corner of the claim is the NW Corner of Sec 20, T9N, R4W.

The above information is shown on the attached map. DATED AND POSTED on the ground this 1st day of September, 2018.

Locators:

Printed Name John Mathis Signature(s)

Address: PO Box 712, Congress, AZ 85332

Printed Name Jody Larsen Signature(s)

Address: 5650 E. Hop Toad Rd, Kingman, AZ. 86401

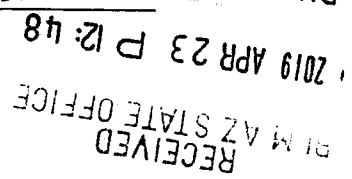

AN09452353

Jody CARSEN
Wendy CARSEN

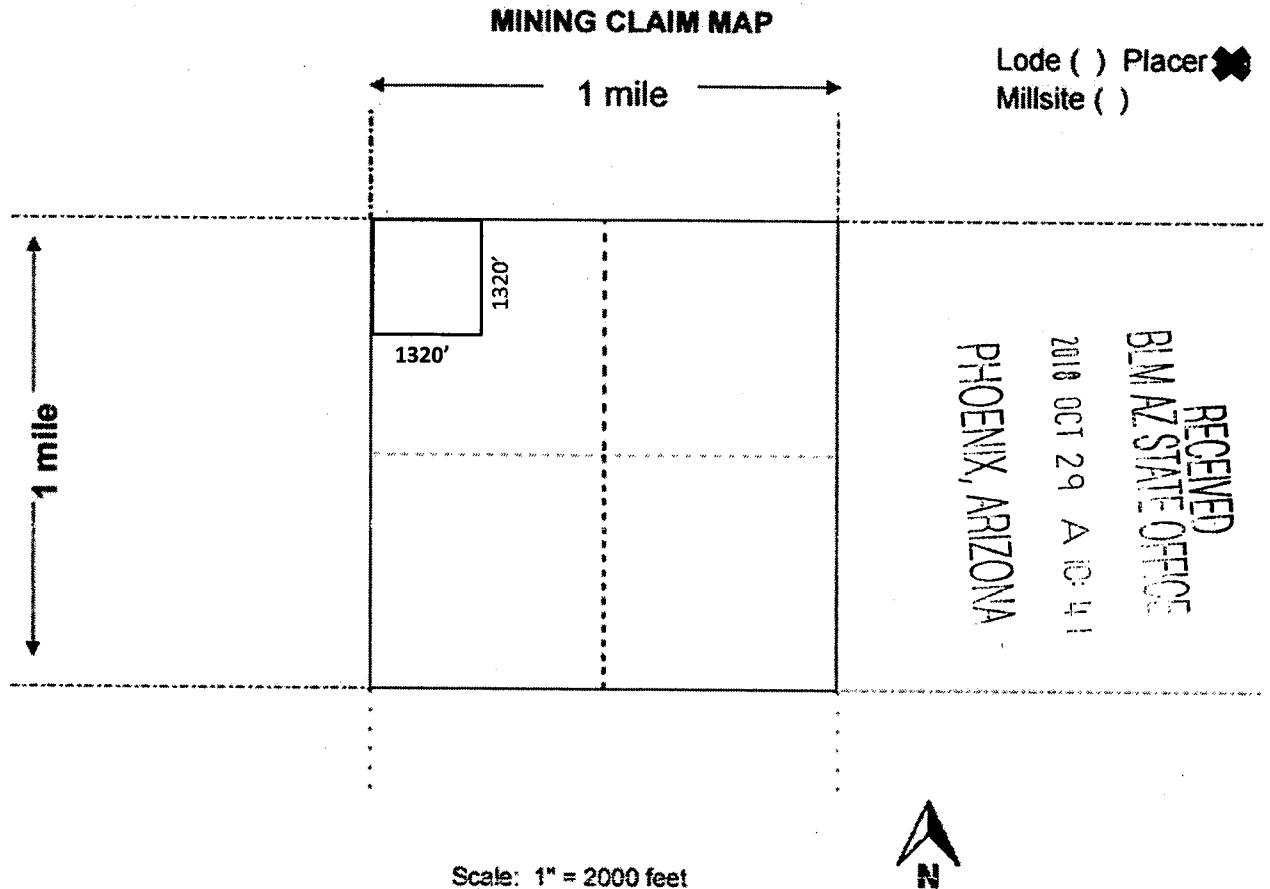

1. The above map depicts the **The Boyz Place 2 NW** mining claim, which is located in Section(s) **20**, Township **9N**, Range **4W**, Gila and Salt River Base and Meridian, **Yavapai** County, Arizona.

Total claim acreage is **40 Acres**.

2. The type of corner and location monuments used are as follows: **Capped PVC, Standing >5' tall.**

3. The bearings and distances in degrees and feet between claim corners and to a public land survey monument are as depicted on the map. **The NW corner of the claim is the NW Corner of Sec 20, T9N, R4W.**

4. If the claim is a placer or millsite claim with exterior limits conforming to legal subdivisions of the public survey, provide a legal description of the **NW ¼ of the NW ¼ of Sec. 20, T9N, R4W of the Gila and Salt River Base and Meridian, Yavapai County, Arizona.**

ANCH 52353

RECEIVED
BLM AZ STATE OFFICE
2019 APR 23 P 12:48
PHOENIX, ARIZONA

x RETURN to:
Jody LARSEN
5650 E. Hop Toad Rd.
Kingman, AZ 86401

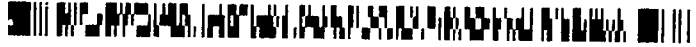

QUIT CLAIM DEED

FOR VALUABLE CONSIDERATION, the sufficiency and receipt of which is hereby acknowledged,
John MATHIS does hereby forever quit claim all his right, title and interest in
the unpatented mining claims described on the supplemental attachment, attached hereto and incorporated
herein by reference, to The Boyz Place 2 SW WENDY LARSEN
WML *WML*

IN WITNESS WHEREOF, grantor has executed this instrument as of this 1 day of November, 2018

[Signature]

Exempt from A.R.S. 11-1133 and 11-1137(B) by A.R.S. 11-1134(A)(6)
See exhibit "A"

STATE OF ARIZONA)
County of Maricopa) ss.

SUBSCRIBED AND SWORN TO before me, a Notary Public, this 20th day of Dec, 2018

By: John Mathis

Notary Public *[Signature]*

My Commission Expires 5/24/21

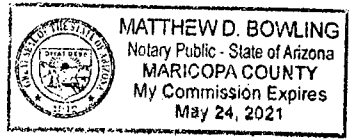

PHOENIX, ARIZONA
2019 APR 23 P 12:47
RECEIVED
AZ STATE OFFICE

[Signature] (TRF)
Form MCF120
Revised July 2014



Exhibit "A"

LOCATION NOTICE FOR PLACER MINING CLAIM

Amendment BLM Serial # _____

NOTICE IS HEREBY GIVEN that the **The Boyz Place 2 SW** placer mining claim has been located by **John Mathis** whose current mailing address is:

PO Box 712, Congress, AZ 85332

BLM
Date
Stamp
2018 OCT 29 A 10:41
PHOENIX, ARIZONA
BLM AZ STATE OFFICE

RECEIVED
BLM AZ STATE OFFICE

The general course of this claim is **North to South** and it is situated in **Yavapai** County, Arizona. This claim is **1320** feet in length and **1320** feet in width.

40 Acres Total Claim Acreage. This claim runs from the location monument on which this location notice is posted at the **NE** corner of the claim approximately **1320** feet in a **South** direction from the **North** end line and **1320** feet in a **West** direction from the **East** end line. This claim is marked by four monuments, one at each corner of the claim. The location monument on which this notice is posted is situated within Section **20**, Township **9N**, Range **4W**, Gila Salt River Base and Meridian, Arizona. This claim encompasses portions of the following legal subdivision(s) if located by legal subdivision or the following quarter section(s), section(s), Township(s) and Range(s) **SW ¼ of the NW ¼ of Sec. 20, T9N, R4W**, Gila Salt River Base and Meridian, Arizona. The locality of this claim with reference to some natural object or permanent monument and additional information (if any) concerning its locality are as follows: **The NW corner of the claim is 1320' South of the NW Corner of Sec 20, T9N, R4W.**

The above information is shown on the attached map. DATED AND POSTED on the ground this **1st** day of **September**, 2018.

Locators:

Printed Name John Mathis Signature(s)

Address: PO Box 712, Congress, AZ 85332

Printed Name Wendy Larsen Signature(s)

Address: 5650 E. Hop Toad Rd. Kingman, AZ 86401

PHOENIX, ARIZONA

2019 APR 23 P 12:47

RECEIVED
BLM AZ STATE OFFICE

APR 23 2019

Wendy LARSEN
Jody LARSEN

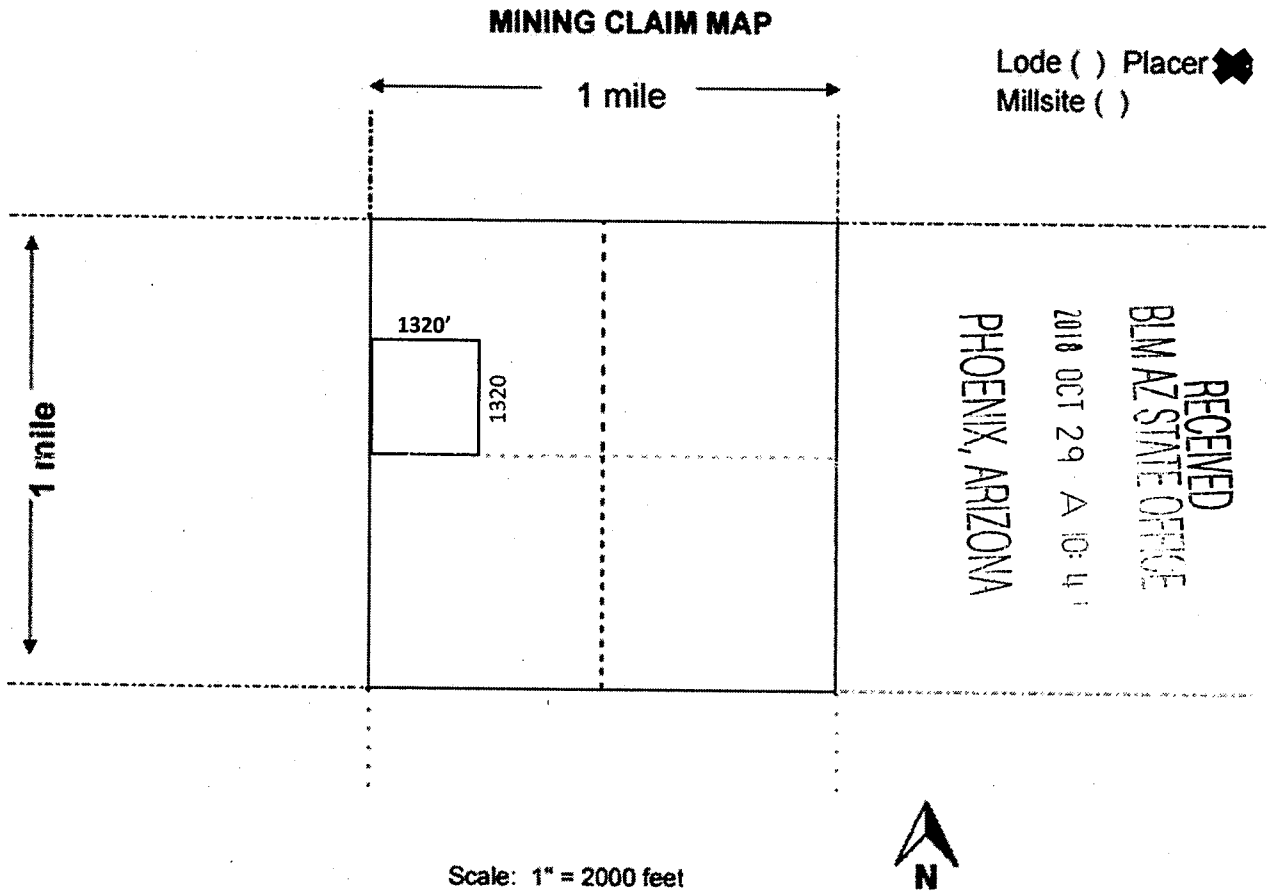

1. The above map depicts the **The Boyz Place 2 SW** mining claim, which is located in Section(s) **20**, Township **9N**, Range **4W**, Gila and Salt River Base and Meridian, **Yavapai** County, Arizona.

Total claim acreage is **40 Acres**.

2. The type of corner and location monuments used are as follows. **Capped PVC, Standing >5' tall.**

3. The bearings and distances in degrees and feet between claim corners and to a public land survey monument are as depicted on the map. **The NW corner of the claim is 1320' South of the NW Corner of Sec 20, T9N, R4W.**

4. If the claim is a placer or millsite claim with exterior limits conforming to legal subdivisions of the public survey, provide a legal description of the **SW ¼ of the NW ¼ of Sec. 20, T9N, R4W of the Gila and Salt River Base and Meridian, Yavapai County, Arizona.**

A110452354

RECEIVED
BLM AZ STATE OFFICE
2019 APR 23 10:21 AM
PHOENIX, ARIZONA

Return to:
Jody LARSEN
5650 E. Hop Toad Rd
Kingman, AZ 86401

2019-0013709 QCD Page: 1 of 3
03/27/2019 11:06:10 AM
Leslie M. Hoffman
OFFICIAL RECORDS OF YAVAPAI COUNTY \$15.00
JODY LARSEN



QUIT CLAIM DEED

FOR VALUABLE CONSIDERATION, the sufficiency and receipt of which is hereby acknowledged,
John MATHIS does hereby forever quit claim all his right, title and interest in
the unpatented mining claims described on the supplemental attachment, attached hereto and incorporated
herein by reference, to The Boy's Place 2 SE JIM NOWLING

IN WITNESS WHEREOF, grantor has executed this instrument as of this 1 day of November, 2018

Exempt from A.R.S. 11-1133 and 11-1137(B) by A.R.S. 11-1134(A)(6)

See Exhibit "A"

STATE OF ARIZONA)
County of Maricopa) ss.

SUBSCRIBED AND SWORN TO before me, a Notary Public, this 20th day of Dec, 2018

By: John Mathis

Notary Public [Signature]

My Commission Expires 5/24/21

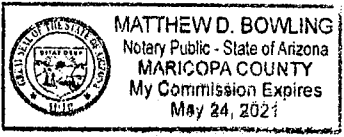

PHOENIX, ARIZONA

Form MCF120
Revised July 2014

2019 APR 23 P 12:48

This form is available from the Arizona Geological Survey and may be reproduced.

RECEIVED
PLM AZ STATE OFFICE



Exhibit "A"

LOCATION NOTICE FOR PLACER MINING CLAIM

Amendment BLM Serial # _____

NOTICE IS HEREBY GIVEN that the **The Boyz Place 2 SE** placer mining claim has been located by **John Mathis** whose current mailing address is:

→ **PO Box 712, Congress, AZ 85332**

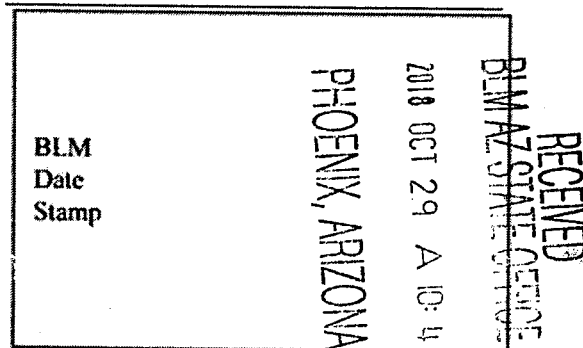

The general course of this claim is **North to South** and it is situated in **Yavapai** County, Arizona. This claim is **1320** feet in length and **1320** feet in width.

40 Acres Total Claim Acreage. This claim runs from the location monument on which this location notice is posted at the **NW** corner of the claim approximately **1320** feet in a **South** direction from the **North** end line and **1320** feet in an **East** direction from the **West** end line. This claim is marked by four monuments, one at each corner of the claim. The location monument on which this notice is posted is situated within Section **20**, Township **9N**, Range **4W**, Gila Salt River Base and Meridian, Arizona. This claim encompasses portions of the following legal subdivision(s) if located by legal subdivision or the following quarter section(s), section(s), Township(s) and Range(s) **SE 1/4 of the NW 1/4 of Sec. 20, T9N, R4W**, Gila Salt River Base and Meridian, Arizona. The locality of this claim with reference to some natural object or permanent monument and additional information (if any) concerning its locality are as follows: **The NW corner of the claim is 1320' South and 1320' East of the NW Corner of Sec 20, T9N, R4W.**

The above information is shown on the attached map. DATED AND POSTED on the ground this **1st** day of **September, 2018**.

Locators:

Printed Name John Mathis Signature(s)

Address: PO Box 712, Congress, AZ 85332

Printed Name Jim Nowling Signature(s)

Address: 508 S 500 W Richfield, UT. 84701

ARIZONA 52355

RECEIVED BLM AZ STATE OFFICE 2019 APR 23 P 12:48 PHOENIX, ARIZONA

JIM Nowling
NANEHE MATOS

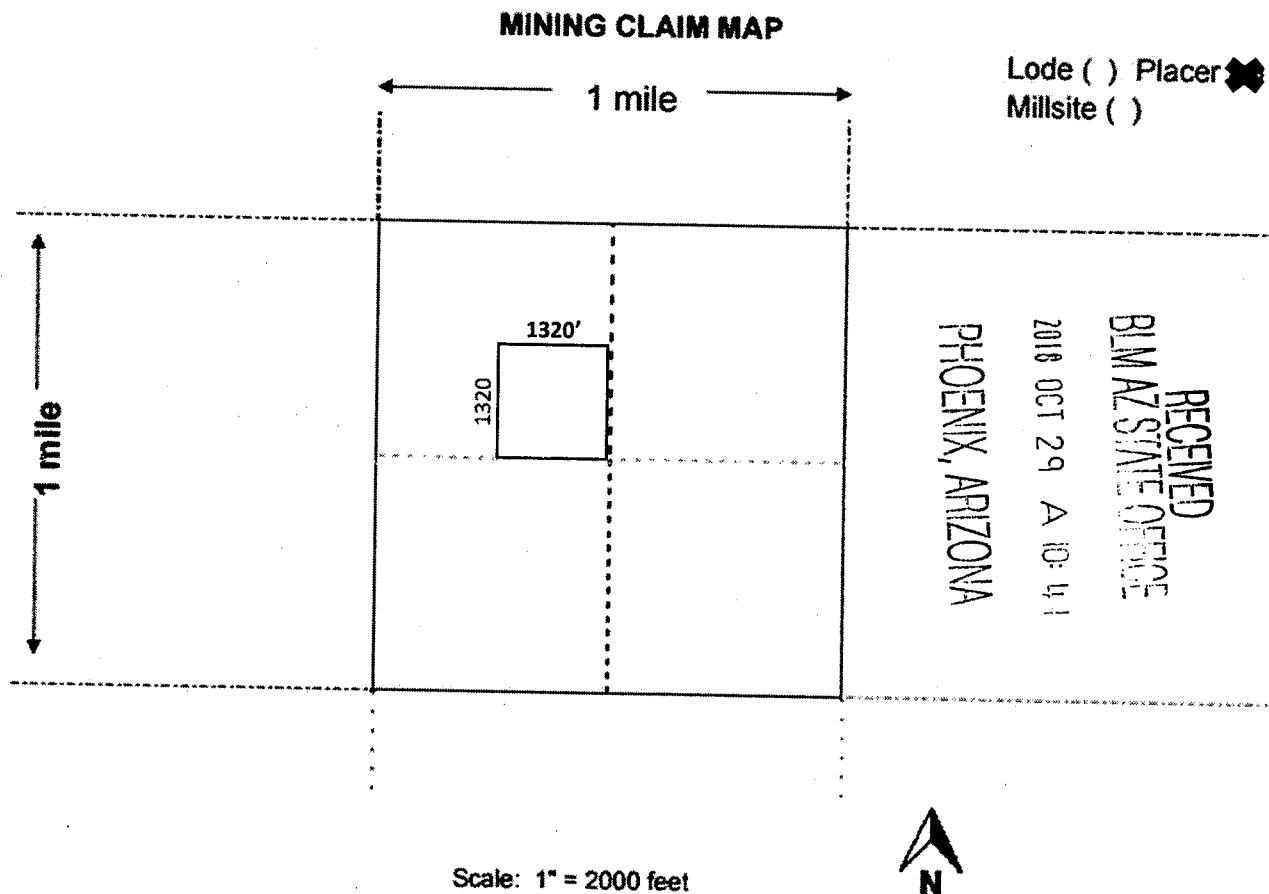

1. The above map depicts the **The Boyz Place 2 SE** mining claim, which is located in Section(s) **20**, Township **9N**, Range **4W**, Gila and Salt River Base and Meridian, **Yavapai** County, Arizona.

Total claim acreage is **40 Acres**.

2. The type of corner and location monuments used are as follows: **Capped PVC, Standing >5' tall**.

3. The bearings and distances in degrees and feet between claim corners and to a public land survey monument are as depicted on the map. **The NW corner of the claim is 1320' South and 1320' East of the NW Corner of Sec 20, T9N, R4W.**

4. If the claim is a placer or millsite claim with exterior limits conforming to legal subdivisions of the public survey, provide a legal description of the **SE ¼ of the NW ¼ of Sec. 20, T9N, R4W of the Gila and Salt River Base and Meridian, Yavapai County, Arizona.**

AN10452355

RECEIVED
BLM AZ STATE OFFICE
2019 APR 23 P 12:48
PHOENIX, ARIZONA

United States Department of the Interior
Bureau of Land Management
 DIV OF LANDS, MINRLS & ENERGY
 ONE N CENTRAL AVE
 PHOENIX, AZ 85004 -4427
 Phone: 602-417-9200

Receipt

No: 4434369

Transaction #: 4553680	
Date of Transaction: 04/23/2019	
CUSTOMER:	
JOHN MATHIS PO BOX 712 CONGRESS, AZ 85332-0712 US	

LINE #	QTY	DESCRIPTION	REMARKS	UNIT PRICE	TOTAL
1	1.00	LOCATABLE MINERALS / MINING CLAIMS-NOT NEW-UNADJUD, ONE AUTH NO. ONLY / MINING CLAIM MONEY RECEIVED CASES: AMC452352/\$60.00	TRANSFERS (4)	- n/a -	60.00
TOTAL:					\$60.00

PAYMENT INFORMATION					
NOTE: Items will appear on credit card statement as "Bureau of Land Mgmt CO".					
1	AMOUNT:	60.00	POSTMARKED:	N/A	
	TYPE:	CREDIT CARD	RECEIVED:	04/23/2019	
	NAME:	MATHIS, JOHN PO BOX 712 CONGRESS AZ 85332-0712 US			
	CARD NO:	XXXXXXXXXXXX5936	AUTH CODE:	024027	
	NAME ON CARD:	WENDY LARSEN			
	SIGNATURE:				

REMARKS

This receipt was generated by the automated BLM Collections and Billing System and is a paper representation of a portion of the official electronic record contained therein.

NOTICE!!

These documents have been scanned!

Do not place un-scanned documents beneath this notice!

Do not remove this notice from this file!

GPO Jacket No. 560-102
Print Order 61540
Rise Business Services, LLC
Job=AZ15 7/11/2019



Box Number= AZ15155



Claim Begin-End: AMC452352-AMC452355

4 Annual Filings



AZ15155-2

AMC452349-AMC452348

UNITED STATES
DEPARTMENT OF THE INTERIOR
BUREAU OF LAND MANAGEMENT

MAINTENANCE FEE WAIVER CERTIFICATION

SEE INSTRUCTIONS ON PAGE 2

447
MK

452352

FORM APPROVED
OMB NO. 1004-0114
Expires: January 31, 2020

- This small miner waiver is filed for the assessment year beginning on September 1, 2019 and ending on September 1, 2020.
- The undersigned and all related parties owned ten or fewer mining claims, mill, or tunnel sites located and maintained on Federal lands in the United States of America on September 1, 2019.
- The undersigned have performed the assessment work required by law for each mining claim listed prior to filing this waiver and understand that by filing this form, the undersigned must file an affidavit of assessment work with the Bureau of Land Management (BLM) by the December 30th following the filing of this waiver.
- The undersigned understand that if the assessment work obligation has not yet come due under 30 U.S.C. 28 (for those claims in their first assessment year only), a notice of intent to hold reciting this condition must be recorded by the December 30th following the filing of this waiver.
- The undersigned understand that mill and tunnel sites may also be listed on this waiver and be waived from payment of the maintenance fee, and that a notice of intent to hold for these sites is required to be filed with the BLM by the December 30th following the filing of this waiver.
- The undersigned understand and acknowledge that pursuant to 43 U.S.C. 1212 and 18 U.S.C. 1001, the filing or recording of a false, fictitious, or fraudulent document with the BLM may result in a fine of up to \$250,000, a prison term not to exceed five years, or both.
- The mining claims, mill or tunnel sites for which this waiver from payment of the maintenance fees is requested are:

CLAIM OR SITE NAME	BLM RECORDATION SERIAL NUMBER
1. Boyz Place 2 SE	✓ AMC 452355
2.	
3.	
4.	
5.	
6.	
7.	
8.	
9.	
10.	

RECEIVED
BLM AZ STATE OFFICE
2019 AUG 27 A 8:42
PHOENIX, ARIZONA

The owner(s) (claimants) of the above mining claims and sites are:

Jim Nowling
(Owner's Name - Please Print)
508 S. 500W
(Owner's Mailing Address)

Jim Nowling
(Owner's Signature)
Richfield UT 84701
(City) (State) (Zip Code)

(Owner's Name - Please Print)
(Owner's Mailing Address)

(Owner's Signature)
(City) (State) (Zip Code)

(Owner's Name - Please Print)
(Owner's Mailing Address)

(Owner's Signature)
(City) (State) (Zip Code)

(Owner's Name - Please Print)
(Owner's Mailing Address)

(Owner's Signature)
(City) (State) (Zip Code)

(Continued on page 2)

ENTERED
SEP 16 2019
BY: [Signature]

#4544424

[Signature]

(Owner's Name - Please Print)	(Owner's Signature)		
(Owner's Mailing Address)	(City)	(State)	(Zip Code)
(Owner's Name - Please Print)	(Owner's Signature)		
(Owner's Mailing Address)	(City)	(State)	(Zip Code)
(Owner's Name - Please Print)	(Owner's Signature)		
(Owner's Mailing Address)	(City)	(State)	(Zip Code)
(Owner's Name - Please Print)	(Owner's Signature)		
(Owner's Mailing Address)	(City)	(State)	(Zip Code)

18 U.S.C. 1001 and 43 U.S.C. 1212 make it a crime for any person knowingly and willfully to make to any department or agency of the United States any false, fictitious or fraudulent statements or representations as to any matter within its jurisdiction.

INSTRUCTIONS

1. This certification is made under the provisions of 43 U.S.C. § 1744 and 30 U.S.C. §28-28k and the regulations thereunder (43 CFR Part 3830).
2. The claimant(s) must fill in the dates in paragraph 1 for the beginning and ending of the assessment year for which this waiver is sought.
3. The claimant(s) must fill in the date in paragraph 2 for the beginning of the assessment year for which this waiver is sought.
4. All claim and site names and BLM serial numbers must be listed for the mining claims, mill sites, and tunnel sites for which the waiver is sought.
5. All owners of the mining claims, mill sites, and tunnel sites and their addresses must be given.
6. This waiver form must be signed by all the claimants or their designated agent, in original form. If an agent is designated, a notarized designation of agent, signed by all of the claimants with proper address given, must be submitted with this waiver.
7. This form must be filed no later than September 1st for the upcoming assessment year in the BLM State Office where the mining claims or sites are recorded, or the waiver cannot be granted by the BLM. (Example: To obtain a waiver for the assessment year 2012, which begins on September 1, 2011, you must qualify for and file for a waiver no later than September 1, 2011, in the proper BLM State Office.)
8. For all mining claims which require assessment work, you must record an affidavit of labor on or before the December 30th immediately following the filing of this waiver. For all other mining claims or sites waived, you must record a notice of intent to hold on or before the December 30th immediately following the filing of this waiver.
9. Mill and tunnel sites may also be listed on this waiver and be waived from payment of the maintenance fee. A notice of intent to hold for these sites is required to be filed by the December 30th following the filing of this waiver.

FOR OFFICIAL USE ONLY

UNITED STATES
DEPARTMENT OF THE INTERIOR
BUREAU OF LAND MANAGEMENT

172 AMC

452352

MAINTENANCE FEE WAIVER CERTIFICATION

FORM APPROVED
OMB NO. 1004-0114
Expires: January 31, 2020

SEE INSTRUCTIONS ON PAGE 2

1. This small miner waiver is filed for the assessment year beginning on September 1, 2019 and ending on September 1, 2020
2. The undersigned and all related parties owned ten or fewer mining claims, mill, or tunnel sites located and maintained on Federal lands in the United States of America on September 1, 2019
3. The undersigned have performed the assessment work required by law for each mining claim listed prior to filing this waiver and understand that by filing this form, the undersigned must file an affidavit of assessment work with the Bureau of Land Management (BLM) by the December 30th following the filing of this waiver.
4. The undersigned understand that if the assessment work obligation has not yet come due under 30 U.S.C. 28 (for those claims in their first assessment year only), a notice of intent to hold reciting this condition must be recorded by the December 30th following the filing of this waiver.
5. The undersigned understand that mill and tunnel sites may also be listed on this waiver and be waived from payment of the maintenance fee, and that a notice of intent to hold for these sites is required to be filed with the BLM by the December 30th following the filing of this waiver.
6. The undersigned understand and acknowledge that pursuant to 43 U.S.C. 1212 and 18 U.S.C. 1001, the filing or recording of a false, fictitious, or fraudulent document with the BLM may result in a fine of up to \$250,000, a prison term not to exceed five years, or both.
7. The mining claims, mill or tunnel sites for which this waiver from payment of the maintenance fees is requested are:

CLAIM OR SITE NAME	BLM RECORDATION SERIAL NUMBER
1. <u>The Boyz Place 2 SW</u>	<u>AMC 452354</u>
2.	
3.	
4.	
5.	
6.	
7.	
8.	
9.	
10.	

RECEIVED
BLM RECORDATION OFFICE
2019 AUG -8 P 3:15
FLAGSTAFF, ARIZONA

The owner(s) (claimants) of the above mining claims and sites are:

Wendy LARSEN (Owner's Name - Please Print) Wendy Larsen (Owner's Signature)

5650 Hop Toad Rd (Owner's Mailing Address) Kingman (City) AZ (State) 86401 (Zip Code)

____ (Owner's Name - Please Print) _____ (Owner's Signature)

____ (Owner's Mailing Address) _____ (City) _____ (State) _____ (Zip Code)

____ (Owner's Name - Please Print) _____ (Owner's Signature)

____ (Owner's Mailing Address) _____ (City) _____ (State) _____ (Zip Code)

____ (Owner's Name - Please Print) _____ (Owner's Signature)

____ (Owner's Mailing Address) _____ (City) _____ (State) _____ (Zip Code)

(Continued on page 2)

ENTERED
SEP 11 2019
BY: [Signature]

453114 [Signature]

(Owner's Name - Please Print)	(Owner's Signature)		
(Owner's Mailing Address)	(City)	(State)	(Zip Code)
(Owner's Name - Please Print)	(Owner's Signature)		
(Owner's Mailing Address)	(City)	(State)	(Zip Code)
(Owner's Name - Please Print)	(Owner's Signature)		
(Owner's Mailing Address)	(City)	(State)	(Zip Code)
(Owner's Name - Please Print)	(Owner's Signature)		
(Owner's Mailing Address)	(City)	(State)	(Zip Code)

18 U.S.C. 1001 and 43 U.S.C. 1212 make it a crime for any person knowingly and willfully to make to any department or agency of the United States any false, fictitious or fraudulent statements or representations as to any matter within its jurisdiction.

INSTRUCTIONS

1. This certification is made under the provisions of 43 U.S.C. § 1744 and 30 U.S.C. §28-28k and the regulations thereunder (43 CFR Part 3830).
2. The claimant(s) must fill in the dates in paragraph 1 for the beginning and ending of the assessment year for which this waiver is sought.
3. The claimant(s) must fill in the date in paragraph 2 for the beginning of the assessment year for which this waiver is sought.
4. All claim and site names and BLM serial numbers must be listed for the mining claims, mill sites, and tunnel sites for which the waiver is sought.
5. All owners of the mining claims, mill sites, and tunnel sites and their addresses must be given.
6. This waiver form must be signed by all the claimants or their designated agent, in original form. If an agent is designated, a notarized designation of agent, signed by all of the claimants with proper address given, must be submitted with this waiver.
7. This form must be filed no later than September 1st for the upcoming assessment year in the BLM State Office where the mining claims or sites are recorded, or the waiver cannot be granted by the BLM. (Example: To obtain a waiver for the assessment year 2012, which begins on September 1, 2011, you must qualify for and file for a waiver no later than September 1, 2011, in the proper BLM State Office.)
8. For all mining claims which require assessment work, you must record an affidavit of labor on or before the December 30th immediately following the filing of this waiver. For all other mining claims or sites waived, you must record a notice of intent to hold on or before the December 30th immediately following the filing of this waiver.
9. Mill and tunnel sites may also be listed on this waiver and be waived from payment of the maintenance fee. A notice of intent to hold for these sites is required to be filed by the December 30th following the filing of this waiver.

FOR OFFICIAL USE ONLY

UNITED STATES
DEPARTMENT OF THE INTERIOR
BUREAU OF LAND MANAGEMENT
MAINTENANCE FEE WAIVER CERTIFICATION

173 *JML*

452352

FORM APPROVED
OMB NO. 1004-0114
Expires: January 31, 2020

SEE INSTRUCTIONS ON PAGE 2

- This small miner waiver is filed for the assessment year beginning on September 1, 2019 and ending on September 1, 2020.
- The undersigned and all related parties owned ten or fewer mining claims, mill, or tunnel sites located and maintained on Federal lands in the United States of America on September 1, 2019.
- The undersigned have performed the assessment work required by law for each mining claim listed prior to filing this waiver and understand that by filing this form, the undersigned must file an affidavit of assessment work with the Bureau of Land Management (BLM) by the December 30th following the filing of this waiver.
- The undersigned understand that if the assessment work obligation has not yet come due under 30 U.S.C. 28 (for those claims in their first assessment year only), a notice of intent to hold reciting this condition must be recorded by the December 30th following the filing of this waiver.
- The undersigned understand that mill and tunnel sites may also be listed on this waiver and be waived from payment of the maintenance fee, and that a notice of intent to hold for these sites is required to be filed with the BLM by the December 30th following the filing of this waiver.
- The undersigned understand and acknowledge that pursuant to 43 U.S.C. 1212 and 18 U.S.C. 1001, the filing or recording of a false, fictitious, or fraudulent document with the BLM may result in a fine of up to \$250,000, a prison term not to exceed five years, or both.
- The mining claims, mill or tunnel sites for which this waiver from payment of the maintenance fees is requested are:

CLAIM OR SITE NAME	BLM RECORDATION SERIAL NUMBER
<u>The Boyz Place 2 NE</u> ✓	<u>452352</u>
<u>TR. Boyz Place 2 NW</u>	<u>452353</u>
3.	
4.	
5.	
6.	
7.	
8.	
9.	
10.	

FEDERAL BUREAU OF LAND MANAGEMENT
 2019 AUG -8 P 3:15
 PHOENIX, ARIZONA

The owner(s) (claimants) of the above mining claims and sites are:

Jody LARSEN
(Owner's Name - Please Print)

Jody Larsen
(Owner's Signature)

5650 Hop Toad Rd
(Owner's Mailing Address)

Kingman AZ 86401
(City) (State) (Zip Code)

(Owner's Name - Please Print)

(Owner's Signature)

(Owner's Mailing Address)

(City) (State) (Zip Code)

(Owner's Name - Please Print)

(Owner's Signature)

(Owner's Mailing Address)

(City) (State) (Zip Code)

(Owner's Name - Please Print)

(Owner's Signature)

(Owner's Mailing Address)

(City) (State) (Zip Code)

(Continued on page 2)

RECORDED
SEP 11 2019
BY: *[Signature]*

4531148 NW *[Signature]*

(Owner's Name - Please Print)	(Owner's Signature)		
(Owner's Mailing Address)	(City)	(State)	(Zip Code)
(Owner's Name - Please Print)	(Owner's Signature)		
(Owner's Mailing Address)	(City)	(State)	(Zip Code)
(Owner's Name - Please Print)	(Owner's Signature)		
(Owner's Mailing Address)	(City)	(State)	(Zip Code)
(Owner's Name - Please Print)	(Owner's Signature)		
(Owner's Mailing Address)	(City)	(State)	(Zip Code)

18 U.S.C. 1001 and 43 U.S.C. 1212 make it a crime for any person knowingly and willfully to make to any department or agency of the United States any false, fictitious or fraudulent statements or representations as to any matter within its jurisdiction.

INSTRUCTIONS

1. This certification is made under the provisions of 43 U.S.C. § 1744 and 30 U.S.C. §28-28k and the regulations thereunder (43 CFR Part 3830).
2. The claimant(s) must fill in the dates in paragraph 1 for the beginning and ending of the assessment year for which this waiver is sought.
3. The claimant(s) must fill in the date in paragraph 2 for the beginning of the assessment year for which this waiver is sought.
4. All claim and site names and BLM serial numbers must be listed for the mining claims, mill sites, and tunnel sites for which the waiver is sought.
5. All owners of the mining claims, mill sites, and tunnel sites and their addresses must be given.
6. This waiver form must be signed by all the claimants or their designated agent, in original form. If an agent is designated, a notarized designation of agent, signed by all of the claimants with proper address given, must be submitted with this waiver.
7. This form must be filed no later than September 1st for the upcoming assessment year in the BLM State Office where the mining claims or sites are recorded, or the waiver cannot be granted by the BLM. (Example: To obtain a waiver for the assessment year 2012, which begins on September 1, 2011, you must qualify for and file for a waiver no later than September 1, 2011, in the proper BLM State Office.)
8. For all mining claims which require assessment work, you must record an affidavit of labor on or before the December 30th immediately following the filing of this waiver. For all other mining claims or sites waived, you must record a notice of intent to hold on or before the December 30th immediately following the filing of this waiver.
9. Mill and tunnel sites may also be listed on this waiver and be waived from payment of the maintenance fee. A notice of intent to hold for these sites is required to be filed by the December 30th following the filing of this waiver.

FOR OFFICIAL USE ONLY

MAINTENANCE FEE WAIVER CERTIFICATION

SEE INSTRUCTIONS ON PAGE 2

FORM APPROVED
OMB NO. 1004-0114
Expires: January 31, 2020

452352

173
JML

original signature
COPY on copy

1. This small miner waiver is filed for the assessment year beginning on September 1, 2019 and ending on September 1, 2020.
2. The undersigned and all related parties owned ten or fewer mining claims, mill, or tunnel sites located and maintained on Federal lands in the United States of America on September 1, 2019.
3. The undersigned have performed the assessment work required by law for each mining claim listed prior to filing this waiver and understand that by filing this form, the undersigned must file an affidavit of assessment work with the Bureau of Land Management (BLM) by the December 30th following the filing of this waiver.
4. The undersigned understand that if the assessment work obligation has not yet come due under 30 U.S.C. 28 (for those claims in their first assessment year only), a notice of intent to hold reciting this condition must be recorded by the December 30th following the filing of this waiver.
5. The undersigned understand that mill and tunnel sites may also be listed on this waiver and be waived from payment of the maintenance fee, and that a notice of intent to hold for these sites is required to be filed with the BLM by the December 30th following the filing of this waiver.
6. The undersigned understand and acknowledge that pursuant to 43 U.S.C. 1212 and 18 U.S.C. 1001, the filing or recording of a false, fictitious, or fraudulent document with the BLM may result in a fine of up to \$250,000, a prison term not to exceed five years, or both.
7. The mining claims, mill or tunnel sites for which this waiver from payment of the maintenance fees is requested are:

CLAIM OR SITE NAME	BLM RECORDATION SERIAL NUMBER
THE BOYZ PLACE 2 NE ✓	452352
TR. BOYZ PLACE 2 NW	452353
3.	
4.	
5.	
6.	
7.	
8.	
9.	
10.	

RECEIVED
BLM
2019 AUG -8 P 3:15
PHOENIX ARIZONA

The owner(s) (claimants) of the above mining claims and sites are:

Jody LARSEN
(Owner's Name - Please Print)

5650 HOP TOAD RD
(Owner's Mailing Address)

Jody Larsen
(Owner's Signature)

Kingsman AZ 86401
(City) (State) (Zip Code)

Nannette Mathis
(Owner's Name - Please Print)

PO Box 712
(Owner's Mailing Address)

Nannette Mathis
(Owner's Signature)

Congress AZ 85332
(City) (State) (Zip Code)

(Owner's Name - Please Print)

(Owner's Mailing Address)

(Owner's Signature)

(City) (State) (Zip Code)

(Owner's Name - Please Print)

(Owner's Mailing Address)

(Owner's Signature)

(City) (State) (Zip Code)

(Continued on page 2)

RECEIVED
BY: [Signature]
11/11/2019

4531148

NW
[Signature]

RECEIVED
BLM AZ STATE OFFICE
2019 NOV -6 P 2:23
PHOENIX ARIZONA



United States Department of the Interior



BUREAU OF LAND MANAGEMENT

Arizona State Office

One North Central Avenue, Suite 800

Phoenix, Arizona 85004-4427

www.blm.gov/az/

OCT 09 2019

In Reply Refer To:
3800 (9200) ML
AMC452352

CERTIFIED MAIL - RETURN RECEIPT REQUESTED No. 9214 8901 9403 8391 6916 67

NOTICE

NANNETTE MATHIS : This Notice Affects Those Claims
PO BOX 712 : Shown in the Block Below.
CONGRESS, AZ 85332-0715 :

AMC452352
THE BOYZ PLACE 2 NE

Maintenance Fee Waiver Held for Rejection

This office received the Maintenance Fee Waiver Certification (waiver) for the above listed mining claim(s). The waiver is not properly completed and does not meet the annual filing requirements.

In accordance with 43 Code of Federal Regulations (CFR) 3835.10, the name, address, and original signatures of all owners of the mining claim must be included on the waiver form. Please correct the discrepancy as noted below:

Not all owners of the mining claim(s) have signed the document. Please obtain the missing signatures on the enclosed copy of the waiver. A Serial Register Page is enclosed listing all of the claim owners.

In order to correct the defect in the waiver, per 43 CFR 3835.93, you must provide this office with the requested information within 60 days of your receipt of this notice. If you are unable to provide this information, you have the option of paying the annual maintenance fee of \$165 per claim (\$165 per 20 acres for placer claims larger than 20 acres). If we do not receive the requested corrections or the maintenance fees within the 60 day time frame, the claim(s) will be declared forfeited and closed.

RECEIVED
BLM AZ STATE OFFICE
2019 NOV - 6 P 2:23
PHOENIX, ARIZONA

If additional information is required, please contact Mike Lininger at 602-417-9397. Please include your AMC serial number(s) on all correspondence.

Sincerely,

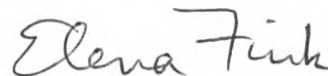

Elena Fink
Deputy State Director
Lands, Minerals and Energy Division

Enclosure(s)

RECEIVED
BLM AZ STATE OFFICE
2019 NOV -6 P 2:23
PHOENIX, ARIZONA

DEPARTMENT OF THE INTERIOR
BUREAU OF LAND MANAGEMENT
MINING CLAIMS

(LIVE) Serial Register Page

Run Date/Time: 9/20/2019 14:37 PM

Page 1 Of 1

01 10-21-1976;090STAT0090;43USC1744

Total Acres

Serial Number

Case Type 384201: PLACER CLAIM

40.000

AMC452352

Claim Name: THE BOYZ PLACE 2 NE

Commodity:

Case Disposition: ACTIVE

Lead File Number

Required Maintenance Fee: 330.00

AMC452352

Name & Address

Interest Relationship

MATHIS NANNETTE	PO BOX 712	CONGRESS AZ 85332-0712	CLAIMANT
LARSEN JODY	5650 E HOP TOAD RD	KINGMAN AZ 86401-8617	CLAIMANT

Mer	Twp	Rng	Sec	Quadrant	District	County / State
14	0090N	0040W	020	NW	HASSAYAMPA FIELD OFFICE	YAVAPAI AZ

Act Date	Code	Action Text	Action Remarks	Receipt Number
09/01/2018	403	LOCATION DATE		
10/29/2018	395	RECORDATION NOTICE RECD	1	4294006
08/08/2019	483	SMALL MINER CERT FILED	2020	
10/29/2018	484	LOCATION YEAR / MAINTENANCE FEE	2019;\$155	4294006
10/29/2018	685	ADDL MAINTENANCE FEE	2019;\$155	4294006
08/08/2019	480	EVID OF ASSMT FILED	2019	4531148
08/08/2019	247	FUTURE ACTION SUSPENSE	2020 WVR CORRECTION	
04/23/2019	396	TRF OF INTEREST FILED	MATHIS JOHN	4434369
10/29/2018	501	ACCT ADV IN LEAD FILE	AMC452352-AMC452355;	4294006
09/13/2018	404	COUNTY RECORDATION	2018-0047457;	

Line Nr Remarks

US Department of the Interior
Bureau of Land Management
1 N Central Ave Ste 800
Phoenix, AZ 85004

USPS CERTIFIED MAIL



9214 8901 9403 8391 6916 67

NANNETTE MATHIS
PO BOX 712
CONGRESS AZ 85332-0715

RECEIVED
BLM AZ STATE OFFICE
2019 NOV -6 P 2:23
PHOENIX, ARIZONA

NOTICE!!

These documents have been scanned!

Do not place un-scanned documents beneath this notice!

Do not remove this notice from this file!

GPO Jacket No. 560-102
Print Order 61540
Rise Business Services, LLC
Job=AZ15 7/11/2019



Box Number= AZ15155



Claim Begin-End: AMC452352-AMC452355

5 Miscellaneous



AZ15155-2

AMC452349-AMC452348

**NO
DOCUMENTS
FOUND**

NO DOCUMENTS FOUND
NO DOCUMENTS FOUND

NOTICE!!

These documents have been scanned!

Do not place un-scanned documents beneath this notice!

Do not remove this notice from this file!

GPO Jacket No. 560-102
Print Order 61540
Rise Business Services, LLC
Job=AZ15 7/11/2019



Box Number= AZ15155



Claim Begin-End: AMC452352-AMC452355

6 Location Notices-Amendments and Supporting Documents



AZ15155-2

AMC452349-AMC452348

MINING CLAIM STATUS REPORT

Date Entered:

11/02/2019

MTP Checked By:

JML

GEO Checked By:

JML

LEAD SERIAL NUMBER:

AMC

452352

thru

AMC

452355

NUMBER OF CLAIMS & TYPE:

LODE
 PLACER
 ASSOCIATION PLACER
 MILL SITE
 TUNNEL SITE

CHARGES:

Processing Fee @ \$20 = \$ 80
 Location Fee @ \$37 = \$ 148
 Maintenance Fee @ \$155 = \$ 620
 Add'l Maint Fee for Assoc Placer = \$ 620
SUBTOTAL \$ 848
 Other Fees \$ _____
 Other Fees \$ _____
TOTAL \$ 1468

TOTAL ACREAGE:

40

Per Claim

(Placer Only)

NUMBER OF LOCATORS:

2

DOCUMENTS RECEIVED VIA:

Over-the-Counter

Mail

TIMELY FILED:

Yes

No

LEGAL DESCRIPTION:

T

9N

R

4W

SEC

20

T

R

SEC

T

R

SEC

T

R

SEC

T

R

SEC

BLM

FOREST SERVICE

SUBJ TO PL 359: Yes

No

WILDERNESS AREA

SPLIT ESTATE:

N/A

SX

PX

OTHER

SRHA

Was proper Notice filed if located on SHRA Land?

Yes

No

RECONVEYED MINERALS ON BLM LAND REQUIRE OPENING ORDER FROM 1944 TO 1993:

Open to Entry On _____

N/A

COMMENTS/STATUS:

VOID

PARTIALLY VOID

PVT MINERALS

WITHDRAWN LANDS

OTHER

AMC452352

Claimant acknowledges that portions of the following claim(s) site(s) may be void or voidable.

Printed Name of Claimant _____

Signature of Claimant _____

*****FINAL ADJUDICATION*****

DATE 3/25/2020

INITIALS PS

Date and Time Run:
3/30/2020 8:48:23 AM

**DEPARTMENT OF THE INTERIOR
BUREAU OF LAND MANAGEMENT
Case Recordation**

Page 1 of 1

Geographic Report with Land

Disposition is equal to **AUTHORIZED , CANCELLED , EXPIRED , PENDING , REJECTED , RELINQUISHED ,
WITHDRAWN**

and Meridian Township Range Section is equal to 14 0090N 0040W 020

and Admin State is equal to AZ

**NO WARRANTY IS MADE BY BLM
FOR USE OF THE DATA FOR
PURPOSES NOT INTENDED BY BLM**

DEPARTMENT OF THE INTERIOR
BUREAU OF LAND MANAGEMENT
Case Recordation
Geographic Report with Land

Admin State: AZ
Geo State: AZ

Serial Number	Total Case Acres:	Case type	Case Disp	Mer	Twp	Rng	Sec	Sur Type	Sur Nr	Surf	Subdivision	Act Pend
AZA 024160	1.000	293200	EXPIRED	14	0090N	0040W	020	FF		1	PORTION OF:	
AZA 032341	1.000	293200	EXPIRED					FF			PORTION OF:	

MINING CLAIM STATUS PORT

Date Entered:

11/02/2019

MTP Checked By:

JML

GEO Checked By:

JML

LEAD SERIAL NUMBER:

AMC

452352

thru

AMC

452355

NUMBER OF CLAIMS & TYPE:

LODE
 PLACER
 ASSOCIATION PLACER
 MILL SITE
 TUNNEL SITE

CHARGES:

Processing Fee @ \$20 = \$ 80
 Location Fee @ \$37 = \$ 148
 Maintenance Fee @ \$155 = \$ 620
 Add'l Maint Fee for Assoc Placer = \$ 620
SUBTOTAL \$ 848
 Other Fees \$ _____
 Other Fees \$ _____
TOTAL \$ 1468

TOTAL ACREAGE:

40

Per Claim

(Placer Only)

NUMBER OF LOCATORS:

2

DOCUMENTS RECEIVED VIA:

Over-the-Counter

Mail

TIMELY FILED:

Yes

No

LEGAL DESCRIPTION:

T

9N

R

4W

SEC

20

T

R

SEC

T

R

SEC

T

R

SEC

T

R

SEC

BLM

FOREST SERVICE

SUBJ TO PL 359:

Yes

No

WILDERNESS AREA

SPLIT ESTATE:

N/A

SX

PX

OTHER

SRHA

Was proper Notice filed if located on SHRA Land?

Yes

No

RECONVEYED MINERALS ON BLM LAND REQUIRE OPENING ORDER FROM 1944 TO 1993:

Open to Entry On _____

N/A

COMMENTS/STATUS:

VOID

PARTIALLY VOID

PVT MINERALS

WITHDRAWN LANDS

OTHER

Claimant acknowledges that portions of the following claim(s) site(s) may be void or voidable.

Printed Name of Claimant _____

Signature of Claimant _____

*****FINAL ADJUDICATION*****

DATE _____

INITIALS _____

AMC 452352



LOCATION NOTICE FOR PLACER MINING CLAIM

Amendment BLM Serial # _____

NOTICE IS HEREBY GIVEN that the **The Boyz Place 2 NE** placer mining claim has been located by **John Mathis** whose current mailing address is:

PO Box 712, Congress, AZ 85332

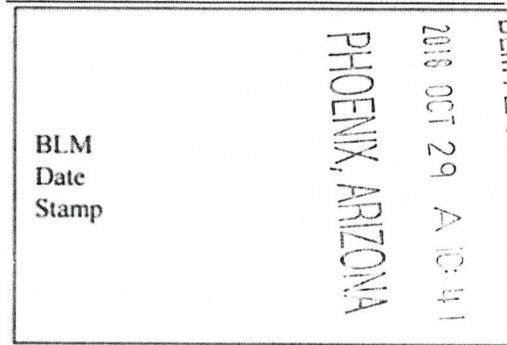

RECEIVED
BLM AZ STATE OFFICE

The general course of this claim is **North to South**

and it is situated in **Yavapai** County, Arizona. This claim is **1320** feet in length and **1320** feet in width.

40 Acres Total Claim Acreage. This claim runs from the location monument on which this location notice is posted at the **SW** corner of the claim approximately **1320** feet in a **North** direction from the **South** end line and **1320** feet in an **East** direction from the **West** end line. This claim is marked by four monuments, one at each corner of the claim. The location monument on which this notice is posted is situated within Section **20**, Township **9N**, Range **4W**, Gila Salt River Base and Meridian, Arizona. This claim encompasses portions of the following legal subdivision(s) if located by legal subdivision or the following quarter section(s), section(s), Township(s) and Range(s) **NE ¼ of the NW ¼ of Sec. 20, T9N, R4W**, Gila Salt River Base and Meridian, Arizona. The locality of this claim with reference to some natural object or permanent monument and additional information (if any) concerning its locality are as follows: **The NW corner of the claim is 1320' East of the NW Corner of Sec 20, T9N, R4W.**

The above information is shown on the attached map. DATED AND POSTED on the ground this **1st** day of **September, 2018**.

Locators:

Printed Name John Mathis Signature(s)

Address: PO Box 712, Congress, AZ 85332

Printed Name Nannette Mathis Signature(s)

Address: PO Box 712, Congress, AZ 85332

AR0452352

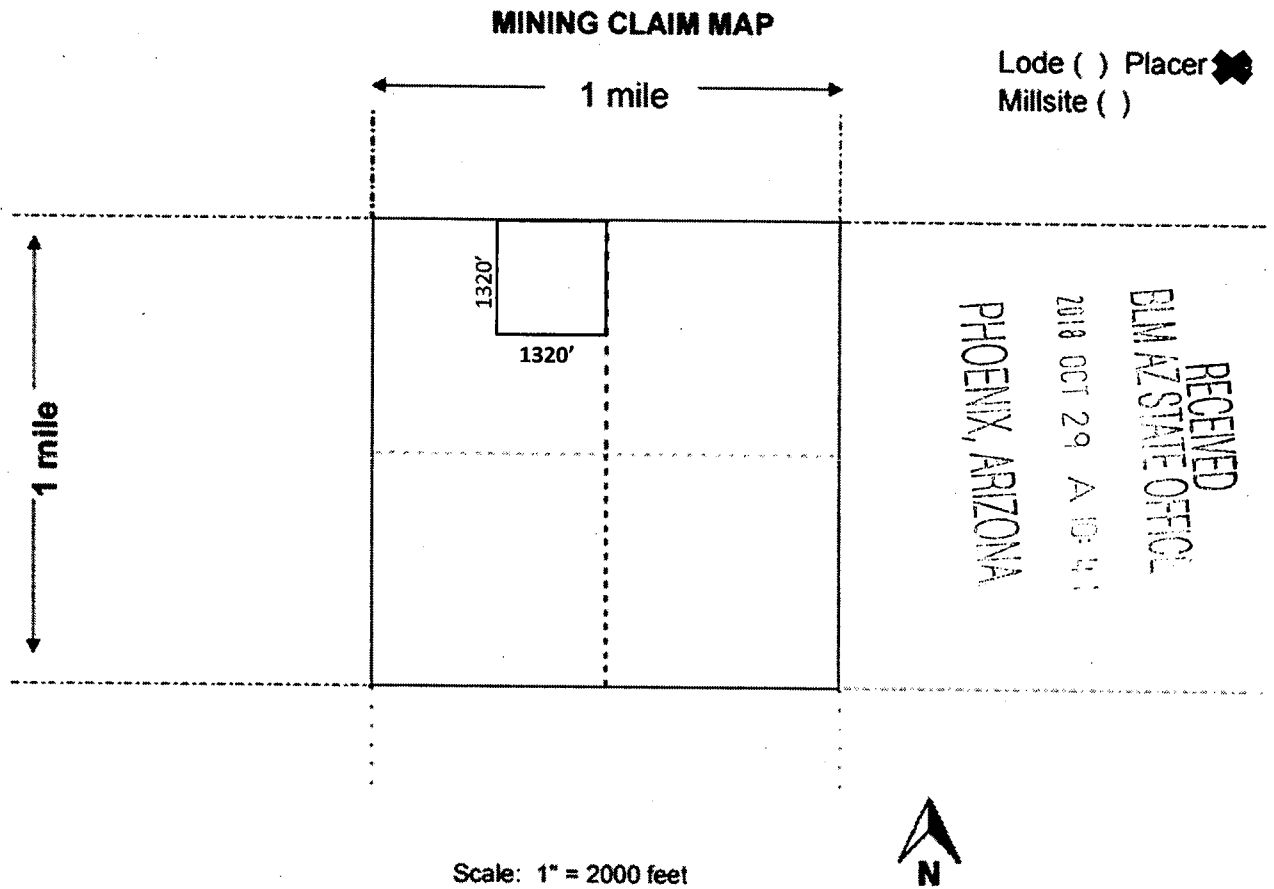

1. The above map depicts the **The Boyz Place 2 NE** mining claim, which is located in Section(s) **20**, Township **9N**, Range **4W**, Gila and Salt River Base and Meridian, **Yavapai** County, Arizona.

Total claim acreage is **40 Acres**.

2. The type of corner and location monuments used are as follows: **Capped PVC, Standing >5' tall.**

3. The bearings and distances in degrees and feet between claim corners and to a public land survey monument are as depicted on the map. **The NW corner of the claim is 1320' East of the NW Corner of Sec 20, T9N, R4W.**

4. If the claim is a placer or millsite claim with exterior limits conforming to legal subdivisions of the public survey, provide a legal description of the **NE ¼ of the NW ¼ of Sec. 20, T9N, R4W of the Gila and Salt River Base and Meridian, Yavapai County, Arizona.**

A110452352



LOCATION NOTICE FOR PLACER MINING CLAIM

Amendment BLM Serial # _____

NOTICE IS HEREBY GIVEN that the **The Boyz Place 2 NW** placer mining claim has been located by **John Mathis** whose current mailing address is:

PO Box 712, Congress, AZ 85332

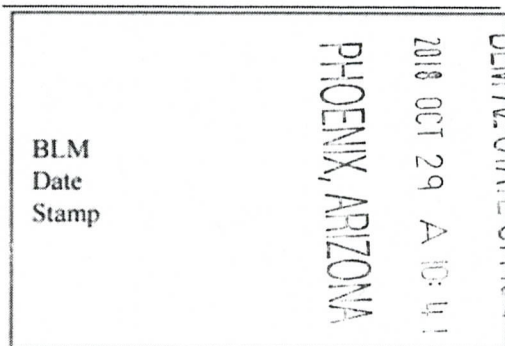

RECEIVED
DLMAZ STATE OFFICE

The general course of this claim is **North to South**

and it is situated in **Yavapai** County, Arizona. This claim is **1320** feet in length and **1320** feet in width.

40 Acres Total Claim Acreage. This claim runs from the location monument on which this location notice is posted at the **SE** corner of the claim approximately **1320** feet in a **North** direction from the **South** end line and **1320** feet in an **West** direction from the **East** end line. This claim is marked by four monuments, one at each corner of the claim. The location monument on which this notice is posted is situated within Section **20**, Township **9N**, Range **4W**, Gila Salt River Base and Meridian, Arizona. This claim encompasses portions of the following legal subdivision(s) if located by legal subdivision or the following quarter section(s), section(s), Township(s) and Range(s) **NW ¼ of the NW ¼ of Sec. 20, T9N, R4W**, Gila Salt River Base and Meridian, Arizona. The locality of this claim with reference to some natural object or permanent monument and additional information (if any) concerning its locality are as follows: **The NW corner of the claim is the NW Corner of Sec 20, T9N, R4W.**

The above information is shown on the attached map. DATED AND POSTED on the ground this **1st** day of **September, 2018**.

Locators:

Printed Name John Mathis Signature(s)

Address: PO Box 712, Congress, AZ 85332

Printed Name Jody Larsen Signature(s)

Address: 5650 E. Hop Toad Rd, Kingman, AZ. 86401

AMC452353

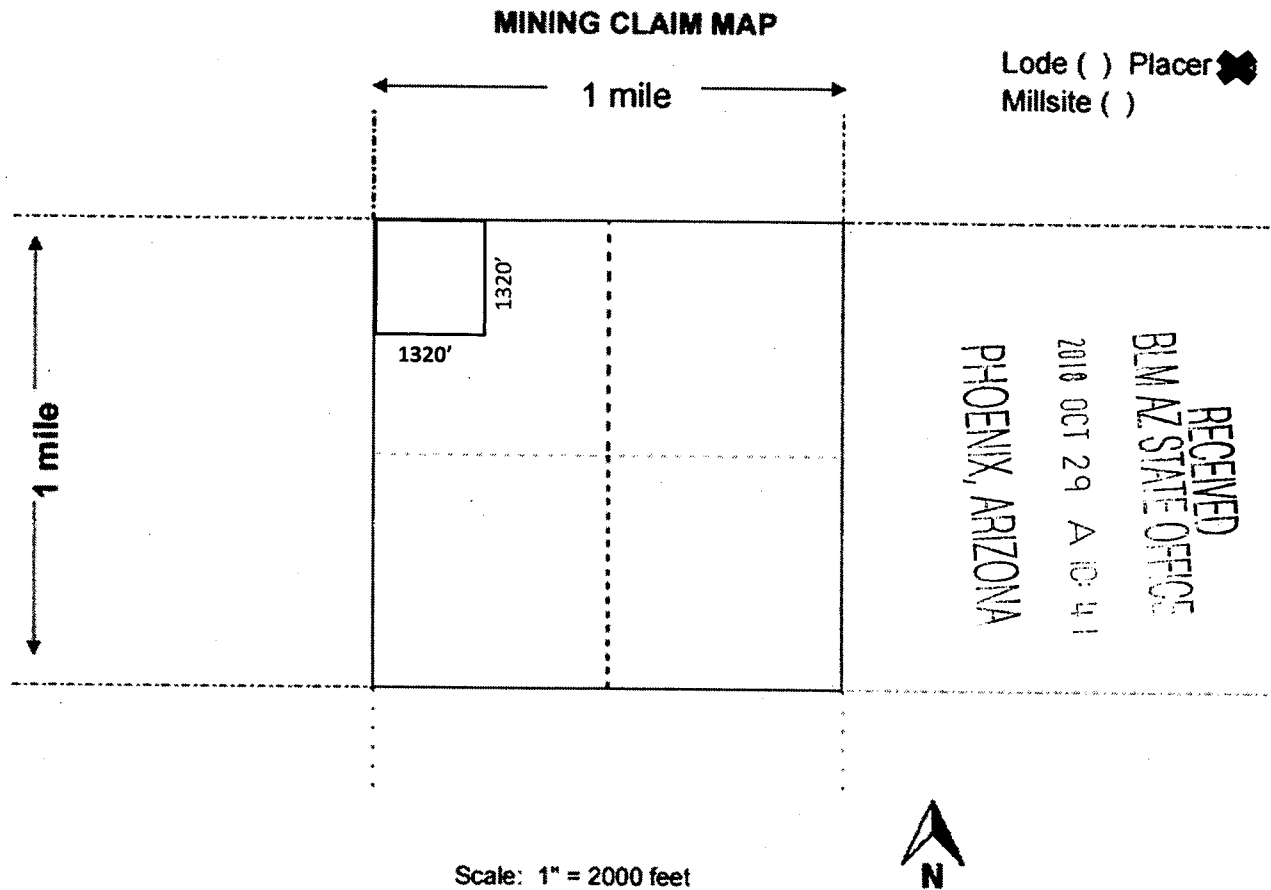

1. The above map depicts the **The Boyz Place 2 NW** mining claim, which is located in Section(s) **20**, Township **9N**, Range **4W**, Gila and Salt River Base and Meridian, **Yavapai** County, Arizona.

Total claim acreage is **40 Acres**.

2. The type of corner and location monuments used are as follows: **Capped PVC, Standing >5' tall.**

3. The bearings and distances in degrees and feet between claim corners and to a public land survey monument are as depicted on the map. **The NW corner of the claim is the NW Corner of Sec 20, T9N, R4W.**

4. If the claim is a placer or millsite claim with exterior limits conforming to legal subdivisions of the public survey, provide a legal description of the **NW ¼ of the NW ¼ of Sec. 20, T9N, R4W of the Gila and Salt River Base and Meridian, Yavapai County, Arizona.**

AN0452353



LOCATION NOTICE FOR PLACER MINING CLAIM

Amendment BLM Serial # _____

NOTICE IS HEREBY GIVEN that the **The Boyz Place 2**
SW placer mining claim has been located by **John**
Mathis whose current mailing address is:

PO Box 712, Congress, AZ 85332

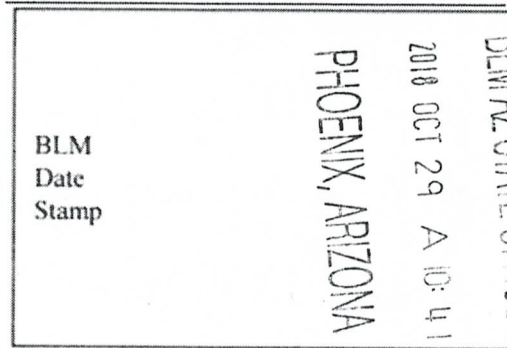

RECEIVED
BLM AZ STATE OFFICE

The general course of this claim is **North to South**
and it is situated in **Yavapai** County, Arizona. This claim is **1320** feet in length and **1320** feet in
width.

40 Acres Total Claim Acreage. This claim runs from the location monument on which this location
notice is posted at the **NE** corner of the claim approximately **1320** feet in a **South** direction from the
North end line and **1320** feet in a **West** direction from the **East** end line. This claim is marked by
four monuments, one at each corner of the claim. The location monument on which this notice is posted
is situated within Section **20**, Township **9N**, Range **4W**, Gila Salt River Base and Meridian, Arizona.
This claim encompasses portions of the following legal subdivision(s) if located by legal subdivision or
the following quarter section(s), section(s), Township(s) and Range(s) **SW ¼ of the NW ¼ of Sec.**
20, T9N, R4W, Gila Salt River Base and Meridian, Arizona. The locality of this claim with reference to
some natural object or permanent monument and additional information (if any) concerning its locality
are as follows: **The NW corner of the claim is 1320' South of the NW Corner of Sec**
20, T9N, R4W.

The above information is shown on the attached map. DATED AND POSTED on the ground this **1st** day
of **September, 2018.**

Locators:

Printed Name John Mathis Signature(s)

Address: PO Box 712, Congress, AZ 85332

Printed Name Wendy Larsen Signature(s)

Address: 5650 E. Hop Toad Rd. Kingman, AZ 86401

AH0452354

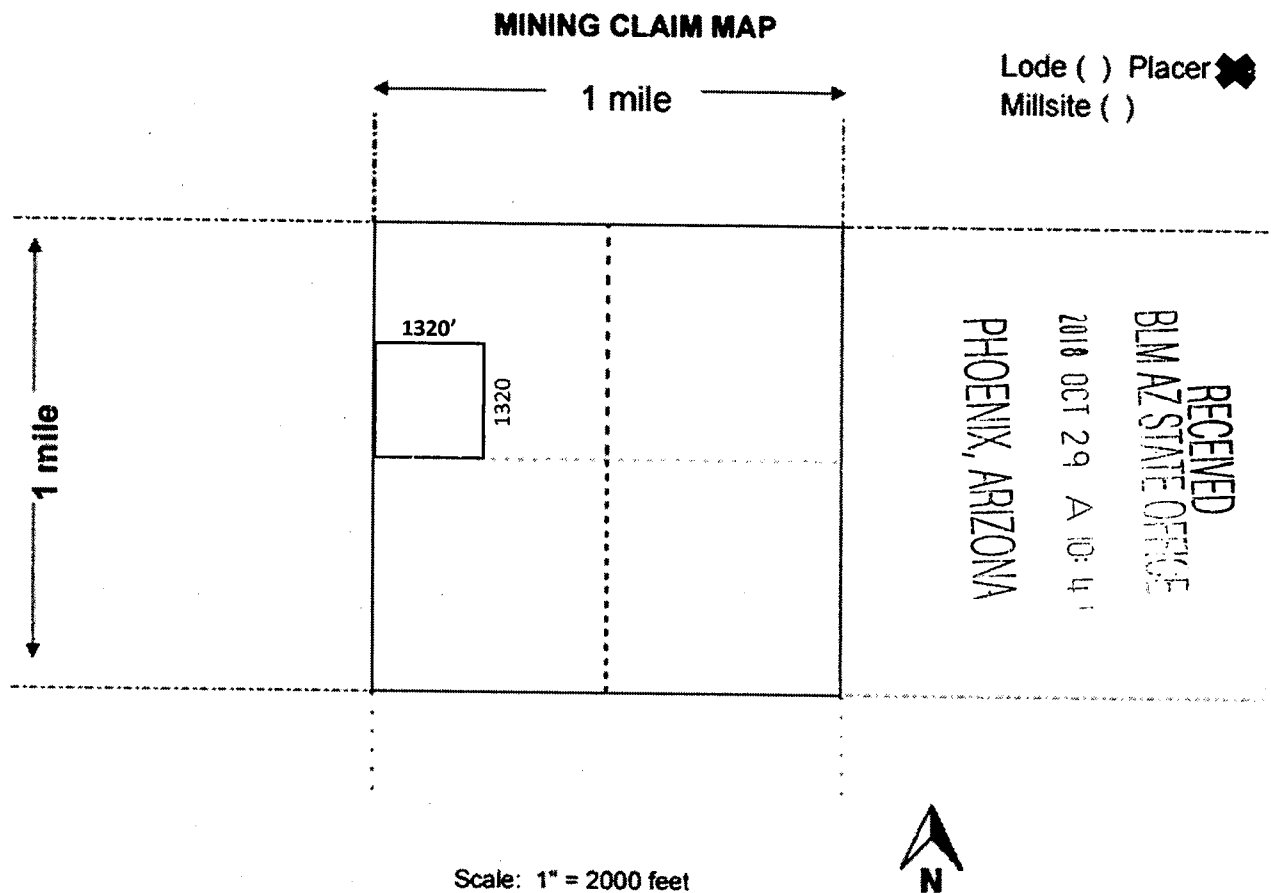

1. The above map depicts the **The Boyz Place 2 SW** mining claim, which is located in Section(s) **20**, Township **9N**, Range **4W**, Gila and Salt River Base and Meridian, **Yavapai** County, Arizona.

Total claim acreage is **40 Acres**.

2. The type of corner and location monuments used are as follows: **Capped PVC, Standing >5' tall.**

3. The bearings and distances in degrees and feet between claim corners and to a public land survey monument are as depicted on the map. **The NW corner of the claim is 1320' South of the NW Corner of Sec 20, T9N, R4W.**

4. If the claim is a placer or millsite claim with exterior limits conforming to legal subdivisions of the public survey, provide a legal description of the **SW ¼ of the NW ¼ of Sec. 20, T9N, R4W of the Gila and Salt River Base and Meridian, Yavapai County, Arizona.**

A110452354



LOCATION NOTICE FOR PLACER MINING CLAIM

Amendment BLM Serial # _____

NOTICE IS HEREBY GIVEN that the **The Boyz Place 2**
SE placer mining claim has been located by **John**
Mathis whose current mailing address is:

→ **PO Box 712, Congress, AZ 85332**

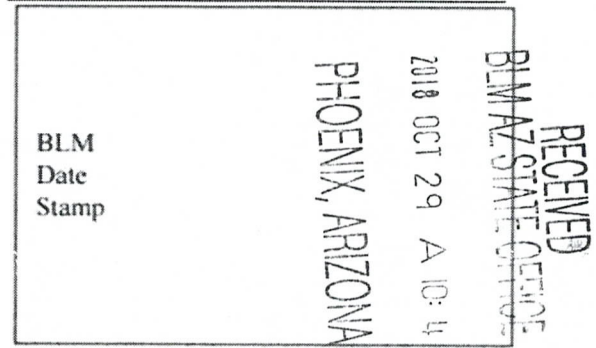

The general course of this claim is **North to South**

and it is situated in **Yavapai** County, Arizona. This claim is **1320** feet in length and **1320** feet in width.

40 Acres Total Claim Acreage. This claim runs from the location monument on which this location notice is posted at the **NW** corner of the claim approximately **1320** feet in a **South** direction from the **North** end line and **1320** feet in an **East** direction from the **West** end line. This claim is marked by four monuments, one at each corner of the claim. The location monument on which this notice is posted is situated within Section **20**, Township **9N**, Range **4W**, Gila Salt River Base and Meridian, Arizona. This claim encompasses portions of the following legal subdivision(s) if located by legal subdivision or the following quarter section(s), section(s), Township(s) and Range(s) **SE ¼ of the NW ¼ of Sec. 20, T9N, R4W**, Gila Salt River Base and Meridian, Arizona. The locality of this claim with reference to some natural object or permanent monument and additional information (if any) concerning its locality are as follows: **The NW corner of the claim is 1320' South and 1320' East of the NW Corner of Sec 20, T9N, R4W.**

The above information is shown on the attached map. DATED AND POSTED on the ground this **1st** day of **September, 2018**.

Locators:

Printed Name John Mathis Signature(s)

Address: PO Box 712, Congress, AZ 85332

Printed Name Jim Nowling Signature(s)

Address: 508 S 500 W Richfield, UT. 84701

ANCH52355

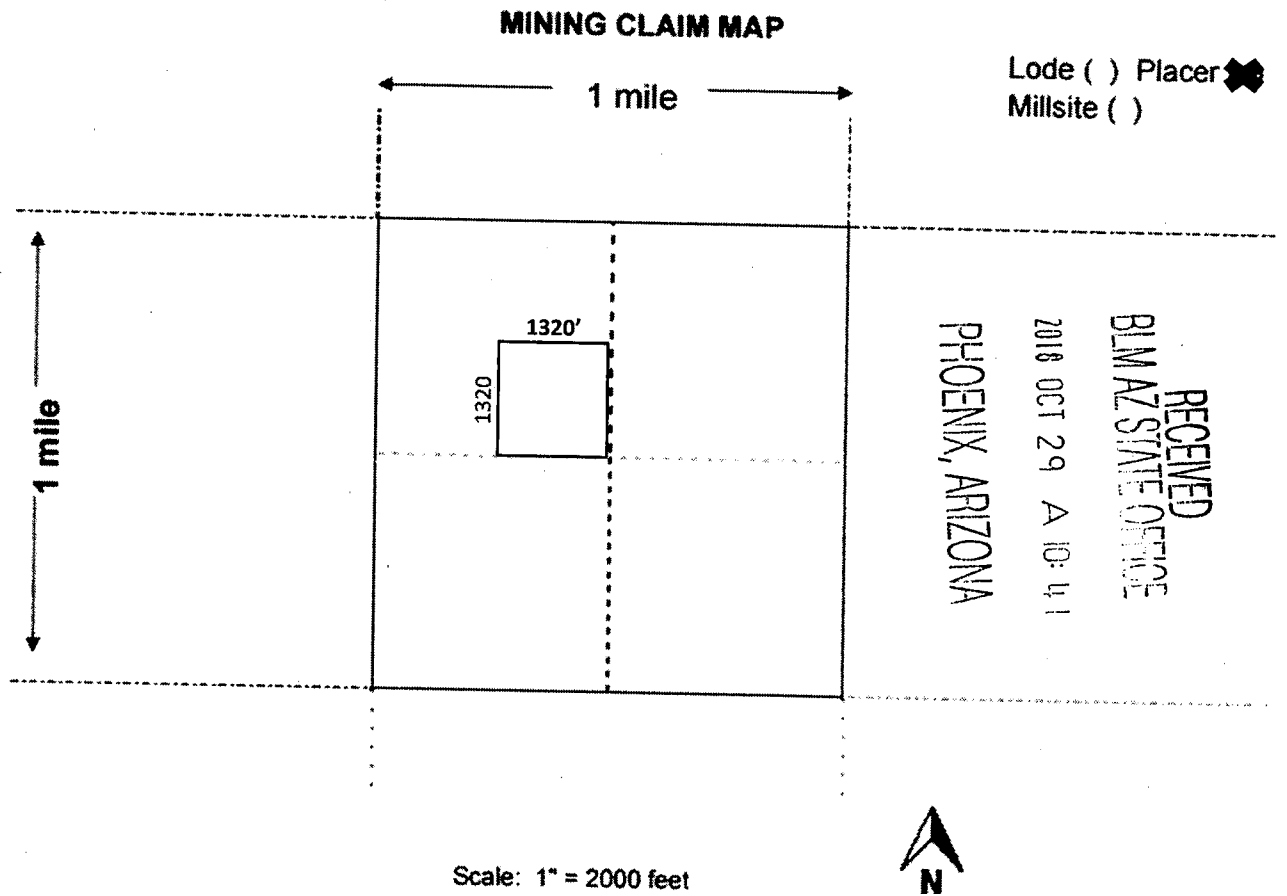

1. The above map depicts the **The Boyz Place 2 SE** mining claim, which is located in Section(s) **20**, Township **9N**, Range **4W**, Gila and Salt River Base and Meridian, **Yavapai** County, Arizona.

Total claim acreage is **40 Acres**.

2. The type of corner and location monuments used are as follows: **Capped PVC, Standing >5' tall.**

3. The bearings and distances in degrees and feet between claim corners and to a public land survey monument are as depicted on the map. **The NW corner of the claim is 1320' South and 1320' East of the NW Corner of Sec 20, T9N, R4W.**

4. If the claim is a placer or millsite claim with exterior limits conforming to legal subdivisions of the public survey, provide a legal description of the **SE ¼ of the NW ¼ of Sec. 20, T9N, R4W of the Gila and Salt River Base and Meridian, Yavapai County, Arizona.**

AMC 452355

